

REGO-FIX▲ powRgrip BT刀桿

MAS 403 / JIS B 6339 / DIN ISO 7388-2

特性與優點

整體精度 TIR \leq 3 μ m @ 3xD

刀柄精度 \leq 1 μ m

錐面精度AT3

表面粗糙度 \leq Ra 0.25

Hi-Q 動平衡系統

所有刀桿動平衡至 G2.5 @25,000rpm / < 1gmm

型號未碼H的刀桿均可搭配Hi-Q動平衡環使用。

最高可調整至80,000rpm

動平衡	
BT30	平衡至 30,000rpm
BT40	G2.5 @25,000rpm
BT50	G2.5 @25,000rpm

抗震性佳

減少震動，實現高品質加工與增加刀具壽命

XL加長刀桿

整體精度TIR \leq 10 μ m

動平衡校正至G2.5 @5,000rpm

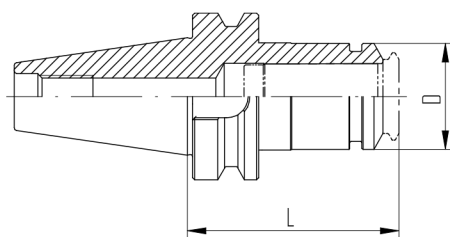

型號	D	D1	D2	L	L1	L2	(mm) FWR
BT 30 / PG 6 x 050	10			50			
BT 30 / PG 6 x 080 H	10			80			225
BT 30 / PG 6 x 100 H	10			100			225
BT 30 / PG 10 x 062	16			62			
BT 30 / PG 10 x 080 H	16			80			285
BT 30 / PG 10 x 120 H	16			120			285
BT 30 / PG 10 x 160 H	16			160			285
BT 30 / PG 15 x 065	24			65			
BT 30 / PG 15 x 070 H	24			70			285
BT 30 / PG 15 x 120 H	24			120			285
BT 30 / PG 25 x 075	40			75			
BT 30 / PG 25 x 080 H	40			80			405
BT 30 / PG 25 x 120 H	40			120			405
BT 30 / PG 25 x 160 H	40			160			405 / 405

REGO-FIX▲ powRgrip BT刀桿

型號	D	D1	D2	L	L1	L2	FWR
BT 40 / PG 10 x 080 H	16			80			285
BT 40 / PG 10 x 120 H	16			120			325
BT 40 / PG 10 x 160 H	16			160			325
BT 40 / PG 10 x 220 XL	16	46	28	220	140	31	
BT 40 / PG 10 x 260 XL	16	46	28	260	140	31	
BT 40 / PG 10 x 300 XL	16	46	28	300	140	31	
BT 40 / PG 10 x 320 XL	16	46	28	320	240	31	
BT 40 / PG 10 x 360 XL	16	46	28	360	240	31	
BT 40 / PG 10 x 400 XL	16	46	28	400	240	31	
BT 40 / PG 15 x 075	24			75			
BT 40 / PG 15 x 080 H	24			80			285
BT 40 / PG 15 x 120 H	24			120			325
BT 40 / PG 15 x 160 H	24			160			325 / 285
BT 40 / PG 15 x 220 XL	24	46	28	220	140	55	
BT 40 / PG 15 x 260 XL	24	46	28	260	140	55	
BT 40 / PG 15 x 300 XL	24	46	28	300	140	55	
BT 40 / PG 15 x 320 XL	24	46	28	320	240	55	
BT 40 / PG 15 x 360 XL	24	46	28	360	240	55	
BT 40 / PG 15 x 400 XL	24	46	28	400	240	55	
BT 40 / PG 25 x 080 H	40			80			405
BT 40 / PG 25 x 120 H	40			120			405
BT 40 / PG 25 x 160 H	40			160			405 / 405
BT 40 / PG 25 x 226 XL	40	55		226	140		
BT 40 / PG 25 x 326 XL	40	55		326	240		
BT 40 / PG 32 x 086	50			86			
BT-B 40 / PG 10 x 080 H	16			80			285
BT-B 40 / PG 10 x 120 H	16			120			325
BT-B 40 / PG 10 x 160 H	16			160			325
BT-B 40 / PG 15 x 075	24			75			
BT-B 40 / PG 15 x 080 H	24			80			285
BT-B 40 / PG 15 x 120 H	24			120			325
BT-B 40 / PG 15 x 160 H	24			160			325 / 285
BT-B 40 / PG 25 x 080 H	40			80			405
BT-B 40 / PG 25 x 120 H	40			120			405
BT-B 40 / PG 25 x 160 H	40			160			405 / 405
BT-B 40 / PG 32 x 086	50			86			

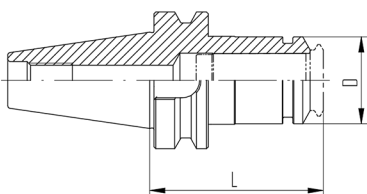

BT / PG

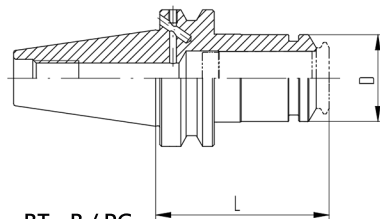

BT - B / PG

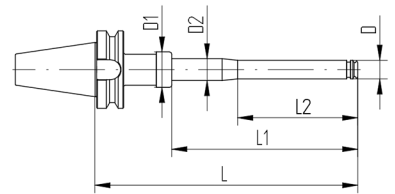

BT / PG XL

REGO-FIX ▲ powRgrip BT刀桿

型號	D	D1	D2	L	L1	L2	FWR
BT 50 / PG 10 x 120 H	16			120			405
BT 50 / PG 10 x 160 H	16			160			405
BT 50 / PG 10 x 240 XL	16	46	28	240	140	31	
BT 50 / PG 10 x 260 XL	16	46	28	260	140	31	
BT 50 / PG 10 x 300 XL	16	46	28	300	140	31	
BT 50 / PG 10 x 340 XL	16	46	28	340	240	31	
BT 50 / PG 10 x 360 XL	16	46	28	360	240	31	
BT 50 / PG 10 x 400 XL	16	46	28	400	240	31	
BT 50 / PG 15 x 120 H	24			120			325
BT 50 / PG 15 x 160 H	24			160			325
BT 50 / PG 15 x 240 XL	24	46	28	240	140	55	
BT 50 / PG 15 x 260 XL	24	46	28	260	140	55	
BT 50 / PG 15 x 300 XL	24	46	28	300	140	55	
BT 50 / PG 15 x 340 XL	24	46	28	340	240	55	
BT 50 / PG 15 x 360 XL	24	46	28	360	240	55	
BT 50 / PG 15 x 400 XL	24	46	28	400	240	55	
BT 50 / PG 25 x 100	40			100			
BT 50 / PG 25 x 120 H	40			120			505
BT 50 / PG 25 x 160 H	40			160			505 / 405
BT 50 / PG 25 x 200 H	40			200			505 / 405
BT 50 / PG 25 x 240 XL	40	55		240	140		
BT 50 / PG 25 x 340 XL	40	55		340	240		
BT 50 / PG 32 x 100	50			100			
BT 50 / PG 32 x 240 XL	50	58		240	140		
BT 50 / PG 32 x 340 XL	50	58		340	240		

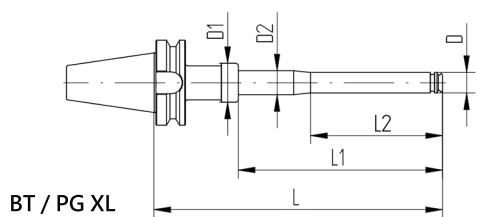
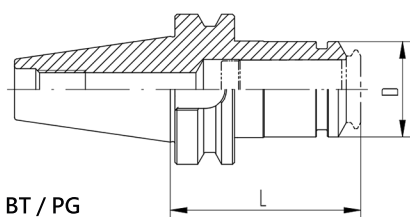

powRgrip BT-OM刀桿

專為HAAS 與 HURCO CNC-machine設計

特殊無驅動槽設計，適用於高速與高精度切削。

BT-OM刀桿的抗震特性，減少主軸與刀桿的磨耗

平衡至G2.5@30,000rpm/<1gmm

加裝動平衡環，可平衡至80,000rpm

筒夾都有中心出水功能(金屬密合)

PG-CF筒夾為外緣出水

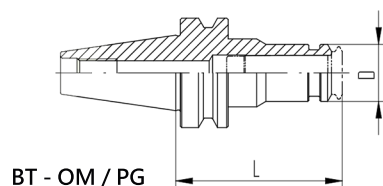

型號	D	L	FWR
BT-OM 30 / PG10 x 062	16	62	-
BT-OM 30 / PG15 x 070H	24	70	285
BT-OM 30 / PG25 x 080H	40	80	405